

WATERFALL AUDIO  
SOUND DESIGNERS

MADE IN FRANCE



*Elora Evo LR*



*Elora Evo Center*

INSTRUCTIONS MANUAL  
COMPACT SPEAKER  
ELORA EVO - CENTER & LR

## INFORMATIONS & OPERATING INSTRUCTIONS

---

**MUST BE CONSULTED BEFORE USE.**

**TO BE KEPT AND PASSED ON IN THE EVENT OF RESALE.**

Thank you for choosing Waterfall Audio speakers. Our deliberate choice for aesthetics and performance constantly guides us towards cutting-edge technologies and design combined with major innovations.

- The Elora Evo loudspeaker is available in a Center (horizontal) or LR (vertical) version. Each speaker is supplied with its own wall bracket.
- If the speakers are to be placed high up, they will need to be oriented towards the listening area. The rear of the Elora Evo has a VESA75 footprint, making it compatible with various mounts that allow this function (please consult us for recommendations). The speakers can also be placed on a flat surface using a special stand (optional).

The Elora Evo is designed to work in perfect symbiosis with all Waterfall Audio loudspeakers, and is strongly recommended for use with a Waterfall Audio subwoofer.

**Warning:** The speaker in your possession is fitted with glass panels. Any impact could cause irreparable damage. This product is fragile, so please bear this in mind when unpacking, installing and using it. It is recommended that you are assisted by a second person, particularly during the final wiring and wall mounting phase.

## ACCESSORIES

---

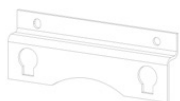

Wall bracket  
(included)

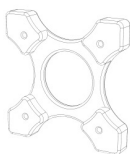

Spacer for VESA bracket  
(optional)

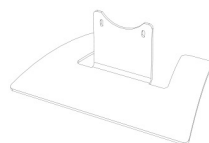

Shelf stand  
(optional)

# ELORA EVO CENTER

## INSTALLATION WITH WALL BRACKET (included)

The speaker's diffusion parameters allow it to be installed at different heights depending on your installation and integration criteria.

The minimum possible height of the bottom of the speaker in relation to the floor is 600mm, the maximum is 1500mm (see next page for the positioning of the wall bracket).

*Minimum height : bottom of speaker at 600mm from floor*

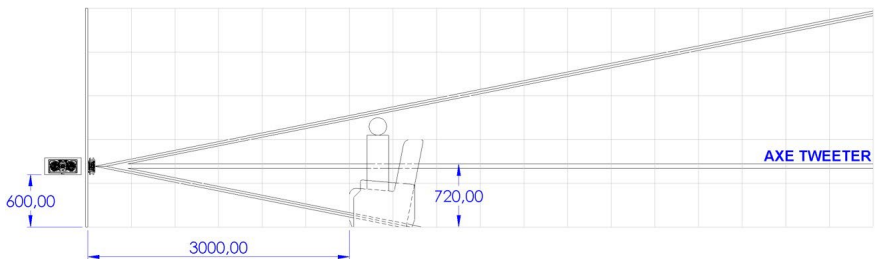

*Maximum height : bottom of speaker at 1500mm from floor*

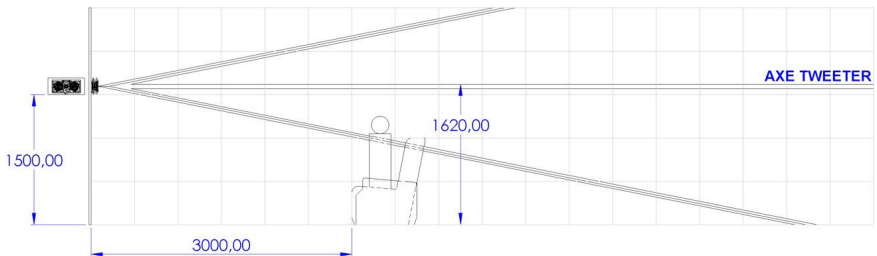

Before installing, check that there is no risk of cutting an electrical cable or damaging a pipe in the wall.

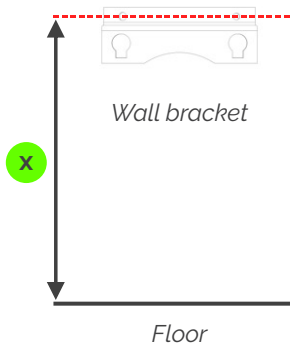

Distance bottom of speaker / floor (in mm)	X = distance floor/ fixing holes (in mm)
600	757
700	857
800	957
900	1057
1000	1157
1100	1257
1200	1357
1300	1457
1400	1557
1500	1657

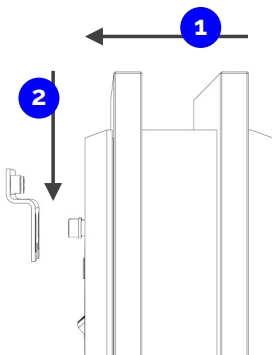
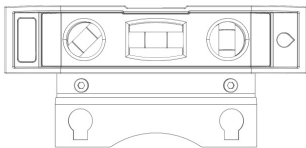

## STEP 1

The speaker weighs 7kg. It is your responsibility to ensure that this load can be accepted and to define the appropriate technical solution for fixing the speaker to the wall.

## STEP 2

Hang the bracket on the wall using 4mm diameter screws (not supplied). There is a small amount of play on the wall bracket to adjust the level. Make sure it is firmly attached to the wall.

## STEP 3

**1** Wire the loudspeaker (make sure that the + and - polarity are correct). Place the screws provided in the bracket.

**2** Lower the speaker so that the screws stop. Make sure it is perfectly in place.

# ELORA EVO CENTER

ON WALL INSTALLATION WITH VESA SUPPORT 75cm (not included)

If the speaker is to be positioned at a height (over 2 m), we recommend using a compatible VESA75 stand to orientate it towards the listener and maintain optimum frequency response.

The rear of the Elora Evo Center speaker has a VESA75 footprint. Example shown here with a Lindy 40875 bracket and a 12° angle. Depending on the type of bracket, it may be necessary to use the optional spacer for cable routing (consult us if necessary).

## Mounting not recommended

*Speaker 2000mm from the floor with wall bracket*

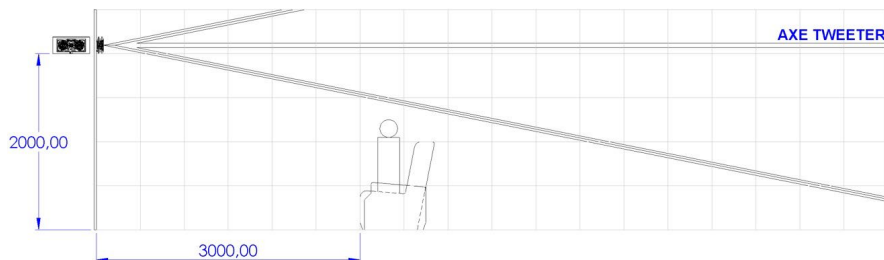

## Recommended mounting

*Speaker 2000mm from the floor at a 12° angle with VESA75 support*

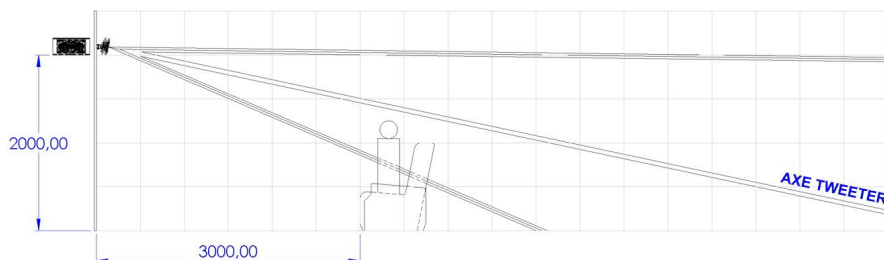

Before installation, check that there is no risk of cutting an electrical cable or damaging a pipe in the wall.

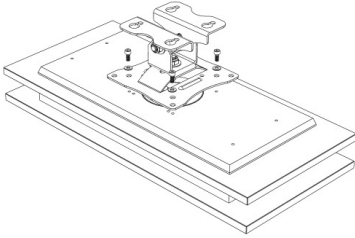

## STEP 1

Insert the screws into the wall to attach the bracket.

Wire up the loudspeaker (make sure to respect the + and - polarities).

Attach it to the VESA bracket using the 4 screws on the back of the speaker. Make sure that the speaker cable is not trapped and that the cables do not come into contact with a metal surface.

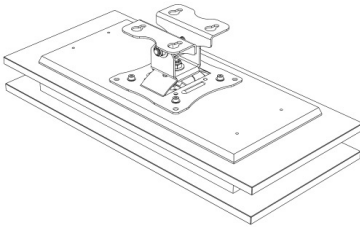

## STEP 2

Check that the stand is firmly attached to the speaker.

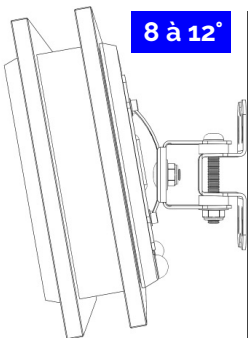

## STEP 3

Hang the unit on the wall.

Position and adjust the angle in relation to your listening distance (generally between 8° and 12°).

# ELORA EVO CENTER

## INSTALLATION ON SHELF STAND (optional)

The Elora Evo Center has an optional shelf stand for installation on a flat surface such as a low cabinet or shelf.

The diffusion parameters allow positioning at different heights depending on your installation and integration criteria.

The minimum possible height from the bottom of the shelf stand to the floor is 200mm; the maximum is 1000mm.

*Minimum height : bottom of shelf stand at 200mm from floor*

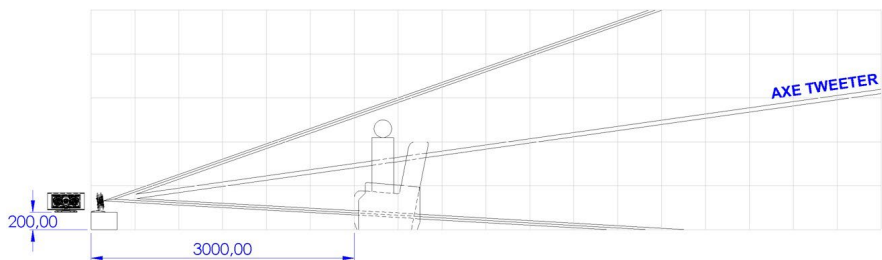

*Maximum height : bottom of shelf stand at 1000mm from floor*

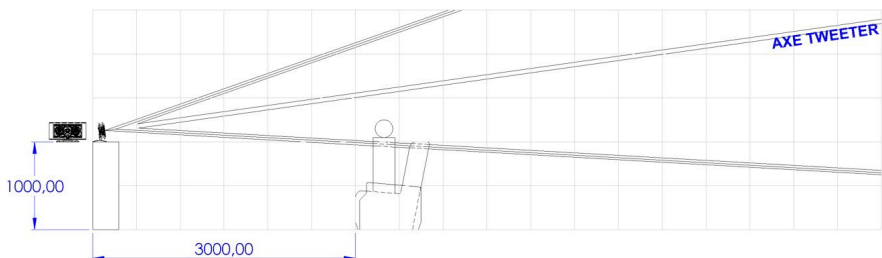

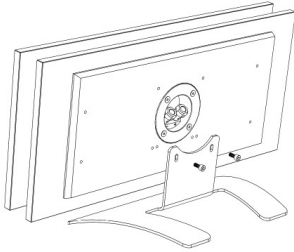

### STEP 1

Remove the 2 screws at the back of the speaker.

Place the shelf stand in front of the 2 holes and replace the screws. Make sure it is firmly attached to the speaker.

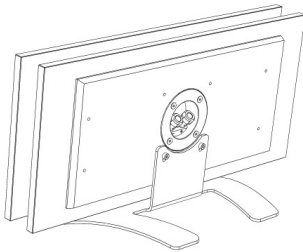

### STEP 2

Wire the loudspeaker (make sure that the + and - polarity are correct).

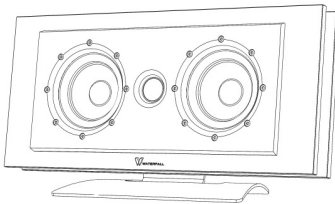

### STEP 3

Place the speaker in its final position.



# ELORA EVO LR

## ON WALL INSTALLATION WITH WALL BRACKET (INCLUDED)

The speaker's diffusion parameters allow it to be installed at different heights depending on your installation and integration criteria.

The minimum possible height from the bottom of the speaker to the floor is 900mm; the maximum is 1400mm (see next page for the positioning of the wall bracket).

*Minimum height : bottom of speaker at 900mm from floor*

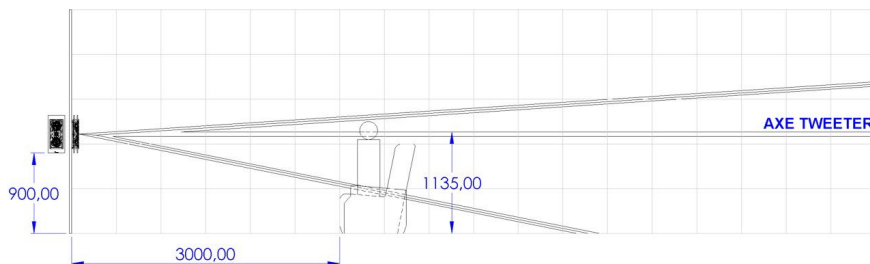

*Maximum height : Bottom of speaker at 1400mm from floor*

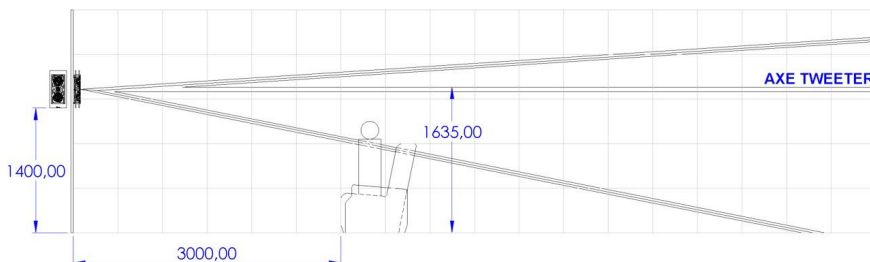

Before installing, check that there is no risk of cutting an electrical cable or damaging a pipe in the wall.

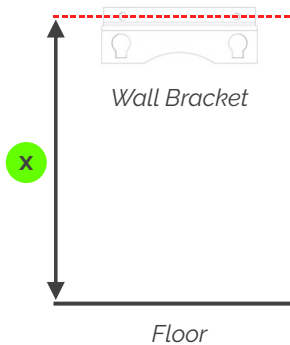

Distance bottom of speaker/floor (in mm)	x = distance floor/mounting holes (in mm)
900	1269
1000	1369
1100	1469
1200	1569
1300	1669
1400	1769

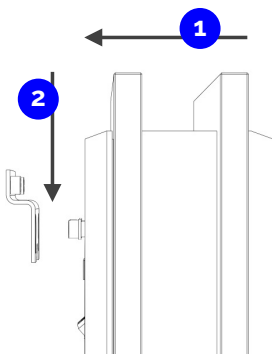
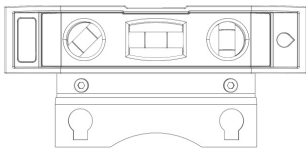

### STEP 1

The speaker weighs 7 kg. It is your responsibility to ensure that this load can be accepted and to define the appropriate technical solution for fixing the speaker to the wall.

### STEP 2

Hang the bracket on the wall using 4mm diameter screws (not supplied). There is a small amount of play on the wall bracket to adjust the level. Make sure it is firmly attached to the wall.

### STEP 3

**1** Wire the loudspeaker (make sure that the + and - polarity are correct). Place the screws provided in the bracket.

**2** Lower the speaker so that the screws stop. Make sure it is perfectly in place.

# ELORA EVO LR

ON WALL INSTALLATION WITH VESA SUPPORT 75cm (not included)

If the loudspeaker is to be positioned at a height (over 2 m), we recommend using a compatible VESA75 support to orientate it towards the listener and maintain optimum frequency response.

The rear of the Elora Evo LR speaker has a VESA75 footprint. Example shown here with a Lindy 40875 bracket and a 12° angle. Depending on the type of bracket, it may be necessary to use the optional spacer for cable routing (consult us if necessary).

## Mounting Not recommended

*Speaker at 2000mm from floor with wall bracket*

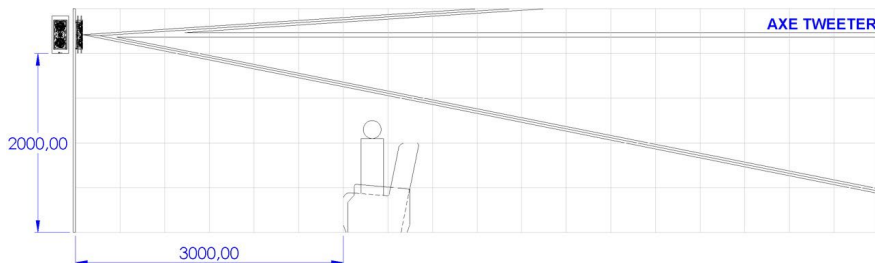

## Recommended Mounting

*Speaker at 2000m from floor at a 10° angle with VESA 75 support*

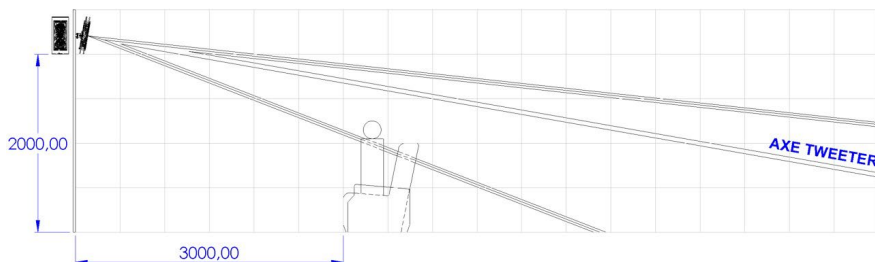

Before installation, check that there is no risk of cutting an electrical cable or damaging a pipe in the wall.

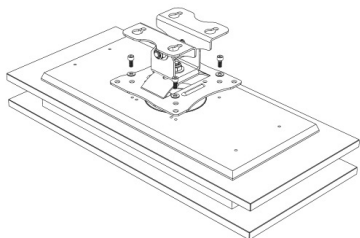

## STEP 1

Insert the screws into the wall to attach the bracket.

Wire up the loudspeaker (make sure to respect the + and - polarities). Attach it to the VESA bracket using the 4 screws on the back of the speaker.

Make sure that the speaker cable is not trapped and that the cables do not come into contact with a metal surface.

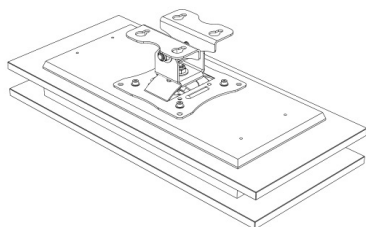

## STEP 2

Check that the bracket is firmly attached to the speaker.

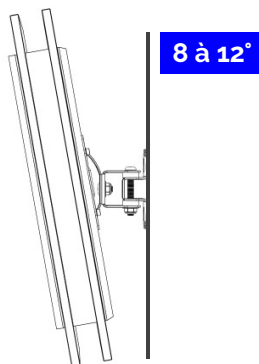

## STEP 3

Hang the unit on the wall.

Position and adjust the angle in relation to your listening distance (generally between 8° and 12°).

# ELORA EVO LR

## INSTALLATION ON SHELF STAND (optional)

The Elora Evo LR has an optional shelf stand for placement on a flat surface such as a low cabinet or shelf.

The diffusion parameters allow positioning at different heights depending on your installation and integration criteria.

The minimum possible height from the bottom of the shelf stand to the floor is 400mm; the maximum is 900mm.

*Minimum height : bottom of shelf stand at 400mm from floor*

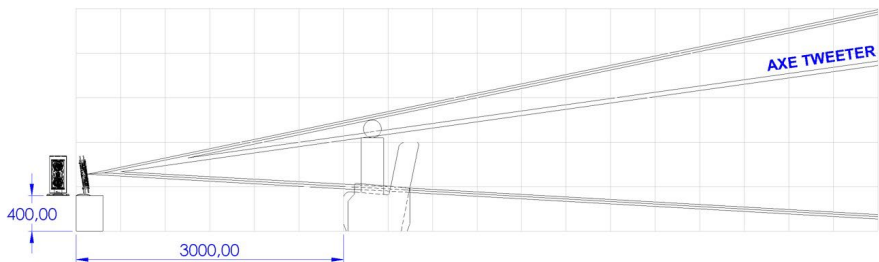

*Maximum height : bottom of shelf stand at 900mm from floor*

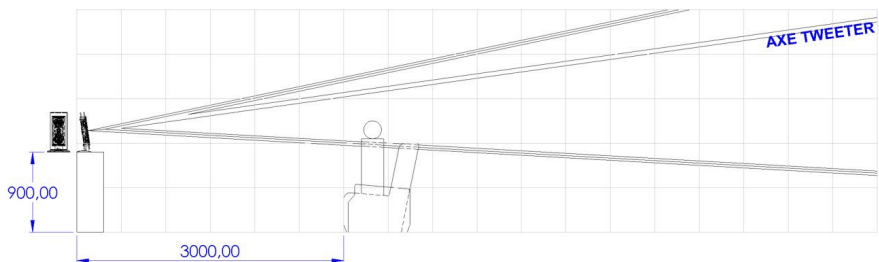

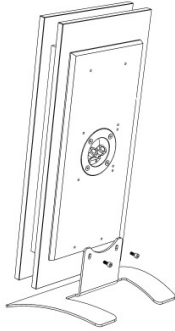

### STEP 1

Remove the 2 screws at the back of the speaker.

Place the shelf stand in front of the 2 holes at bottom of speaker and replace the screws

Make sure it is firmly attached to the speaker.

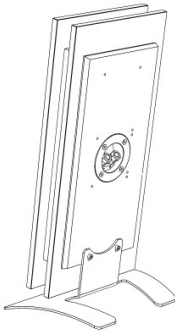

### STEP 2

Wire the loudspeaker (make sure that the + and - polarity are correct).

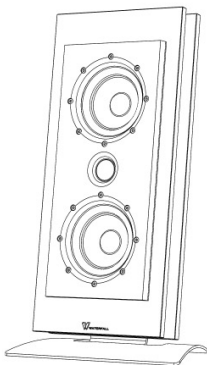

### STEP 3

Place the speaker in its final position.

## ACOUSTIC SET UP AND CONFIGURATION

---

Despite its compact size, the Elora Evo can handle a lot of power thanks to its 'Heatstream' technology. Your choice of amplifier should be a quality model with between 50 Watts and 200 Watts per channel.

We strongly recommend that you combine the Elora Evo with a Waterfall subwoofer, which has been specifically developed to ensure perfect timbre coherence.

The Elora Evo can be used in a 2.1 stereo configuration with a conventional amplifier or in a 5.1 (and higher) home cinema configuration.

Whether in stereo installations or in multi-channel mode, the subwoofer should be as close as possible to the front channels to obtain the best possible blending. The final listening result depends on the quality of the settings during the initial installation.

Don't hesitate to ask your authorized dealer for advice when setting up your installation.

## CONNECTION TO YOUR AMPLIFIER

---

The Elora Evo is connected directly to the speaker outputs of your amplifier or audio video processor.

Make sure that the + and - polarity are correct.

**Never connect two speakers in parallel (or in series) on the same channel. Never connect your speakers to the mains**

The "Waterfall Audio" cable is made from very high quality deoxygenated copper that is particularly well suited to your speakers. It is available from your dealer.



# SET UP & CONFIGURATION IN HOME CINEMA MODE

Your A/V processor has a "Sub Pre Out" output, connect it via the modulation cable (not supplied) to one of the two "Low level Input" inputs on your subwoofer (either L or R). If it has an XLR output, connect it via an XLR cable (not supplied) to the XLR input on your subwoofer. Hi Level Inputs must not be used. Input switching is automatic.

**Do not connect the 2 inputs (XLR and Low Level Input) at the same time.**

## Setting up your Audio Video processor

- Configure all speakers in "small" mode
- Choose 120Hz as the crossover frequency
- Adjust levels and distances

In the case of "auto set up" configurations with microphones, check the consistency of the settings afterwards.

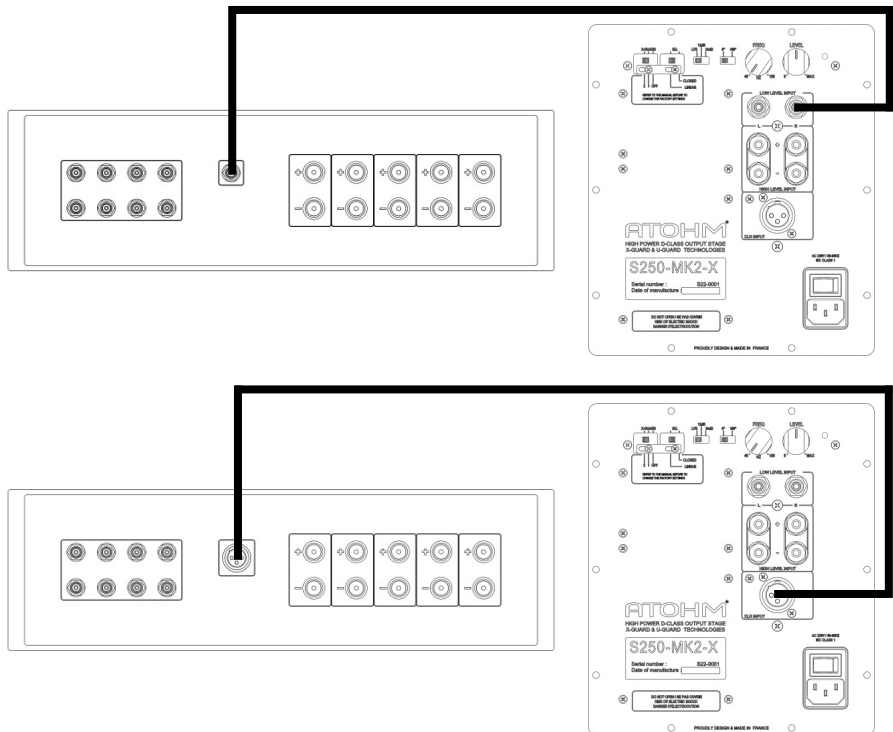



## SET UP OF YOUR WATERFALL SUBWOOFER

---

- Switch "24-12-LFE" to the LFE position (note: on LFE the FREQ button is inactive, the crossover frequency is generated by the processor).
- Adjust the volume ("LEVEL") as required
- PHASE: depending on the processor's bass management settings and certain distance parameters, phase inversion (180°) may be necessary.

A good phase connection will give a dense, homogenous sound reproduction. A poor phase match is characterised by a lack of energy in the lower midrange and an overly present high midrange.

# HIFI SET-UP AND CONFIGURATION (amp with PRE-OUT outputs)

Connect the PRE OUT outputs of your stereo amplifier to the two "Low Level Input" inputs of the subwoofer amplifier.

Do not use the Hi Level Inputs.

Connect the speakers, making sure that the polarity is correct.

Never connect two speakers in parallel on the same channel.

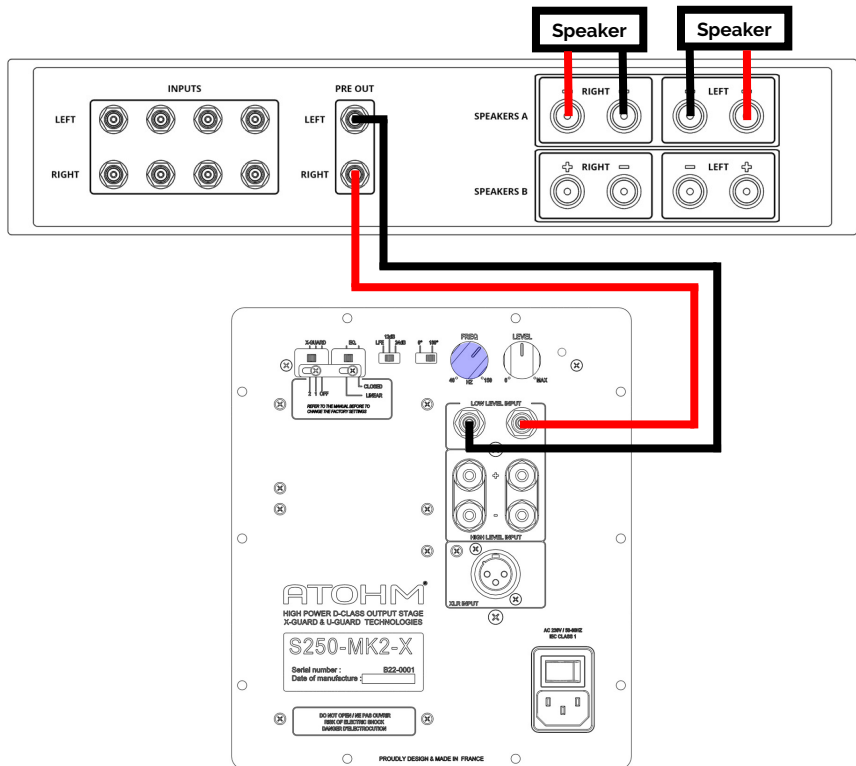

## SET UP OF YOUR WATERFALL SUBWOOFER

- Switch "24-12-LFE" to position 12dB
- Adjust the [FREQ knob towards 2H](#) as shown in the diagram
- PHASE: 180° position
- Adjust the volume LEVEL to your liking
-

# HIFI SET-UP AND CONFIGURATION (amplifier without PRE-OUT outputs)

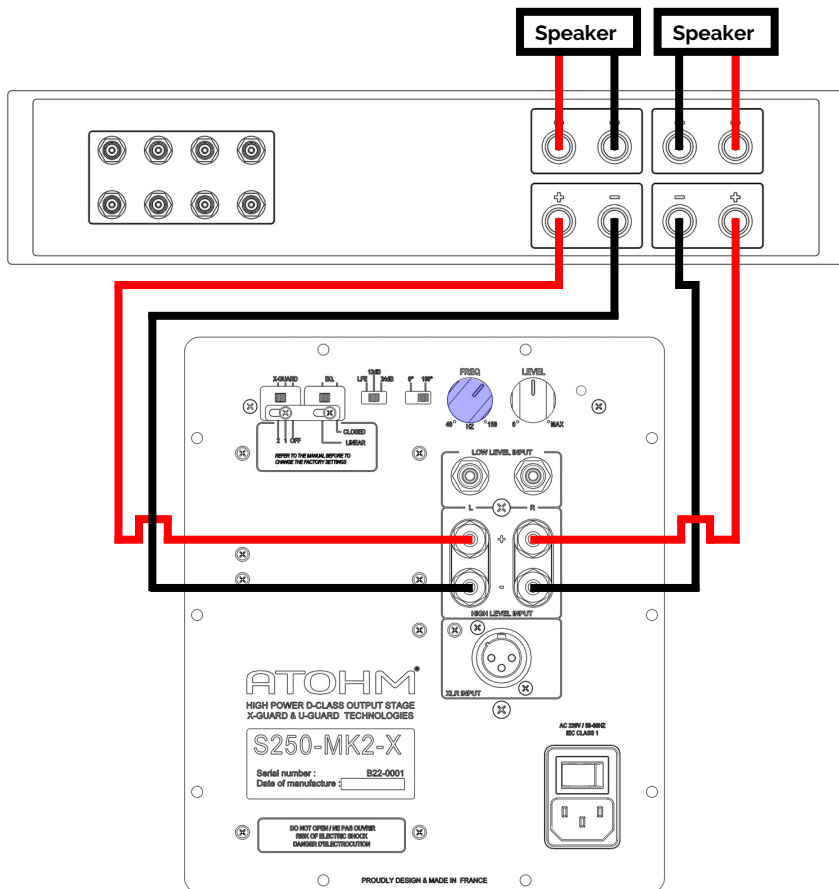

## SET UP OF YOUR WATERFALL SUBWOOFER

- Switch "24-12-LFE" to position 12dB
- Adjust the **FREQ knob** towards 2Hz as shown in the diagram
- PHASE: 180° position
- Adjust the volume ("LEVEL") to your liking

## WARRANTY

---

Waterfall speakers have a 5 years warranty (parts & service) except amplifiers. Waterfall amplifiers have a 2 years warranty (parts & service). Check more on [www.waterfallaudio.com](http://www.waterfallaudio.com) (warranty section).

**THIS DOCUMENT MUST BE PROVIDED IN THE EVENT OF RESALE**

**WATERFALL AUDIO**

ZA les praderies - 83 570 Carcès - France  
[waterfallaudio.com](http://waterfallaudio.com)

Made in France, 5 years warranty on speakers, 2 years warranty on amplifiers (parts& service).  
We operate a policy of continuous improvement and reserve the right to amend designs and specifications without prior notice



All drivers and amplifiers are developed and manufactured by ATOHM (France).